

# Proposed Residential Development, Land East of Pilgrims Way, Roch, Pembrokeshire SA62 6BQ

## "Planning Drawings" - 4 Bed Detached House (2-Storey)

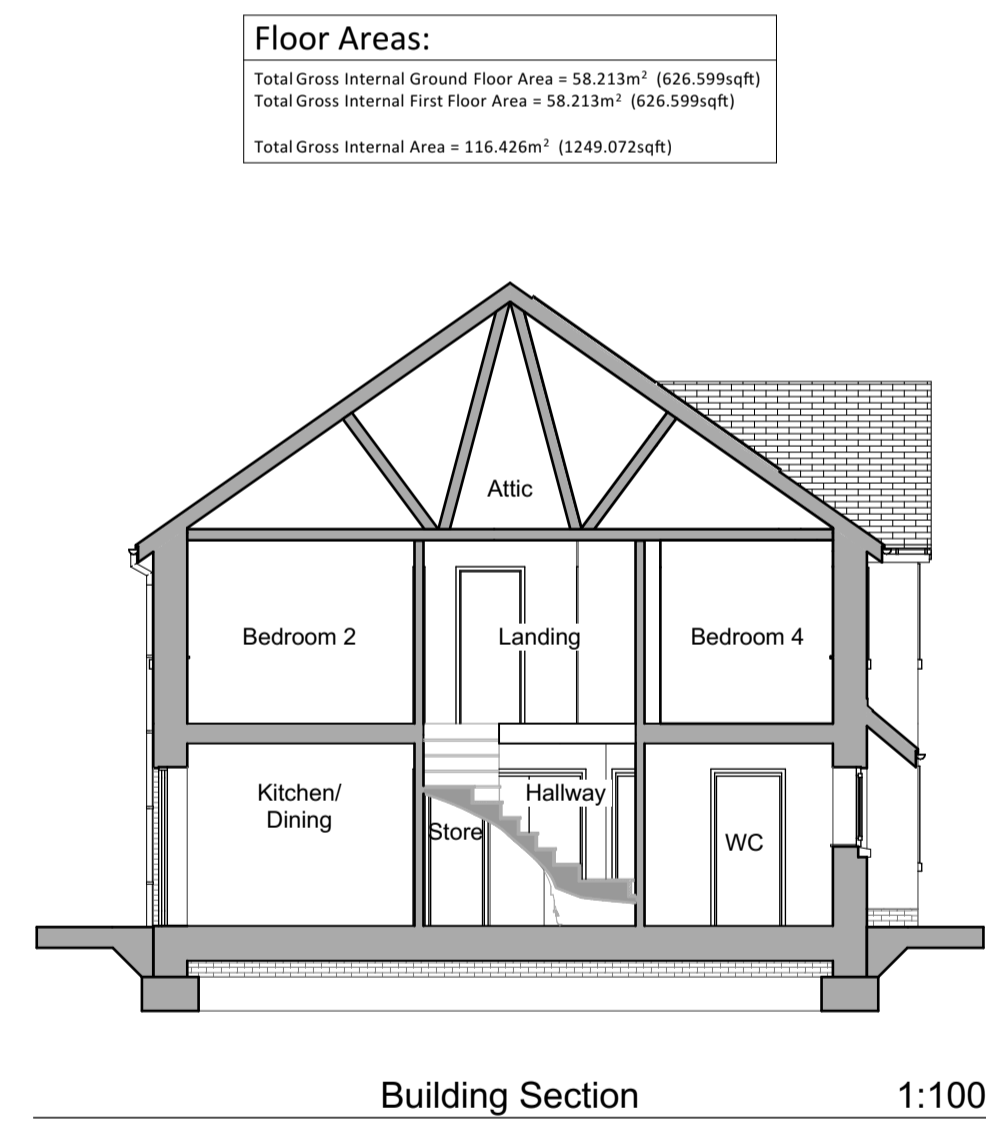

**Floor Areas:**  
 Total Gross Internal Ground Floor Area = 58.213m<sup>2</sup> (626.599sqft)  
 Total Gross Internal First Floor Area = 58.213m<sup>2</sup> (626.599sqft)  
 Total Gross Internal Area = 116.426m<sup>2</sup> (1249.072sqft)

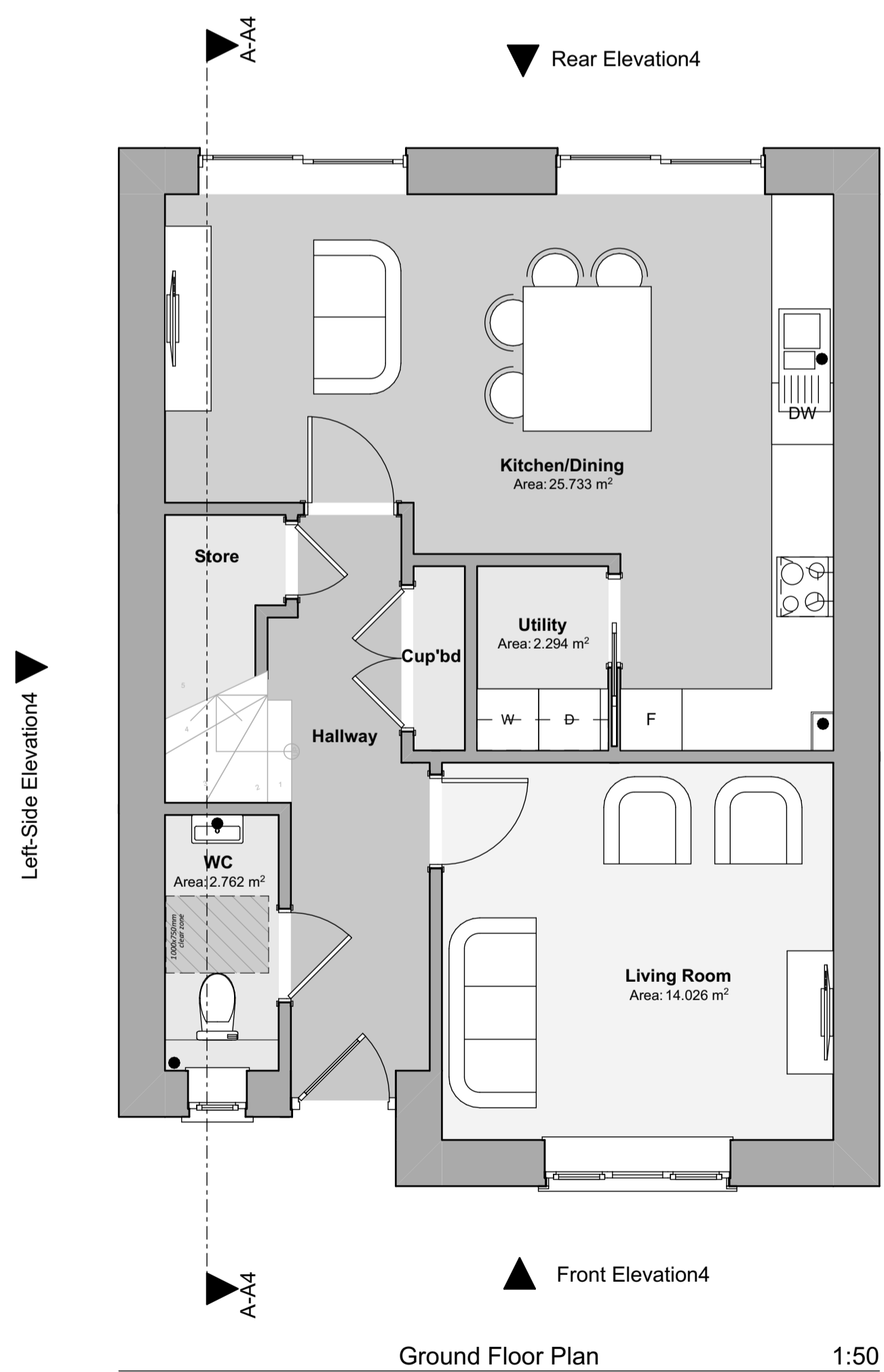
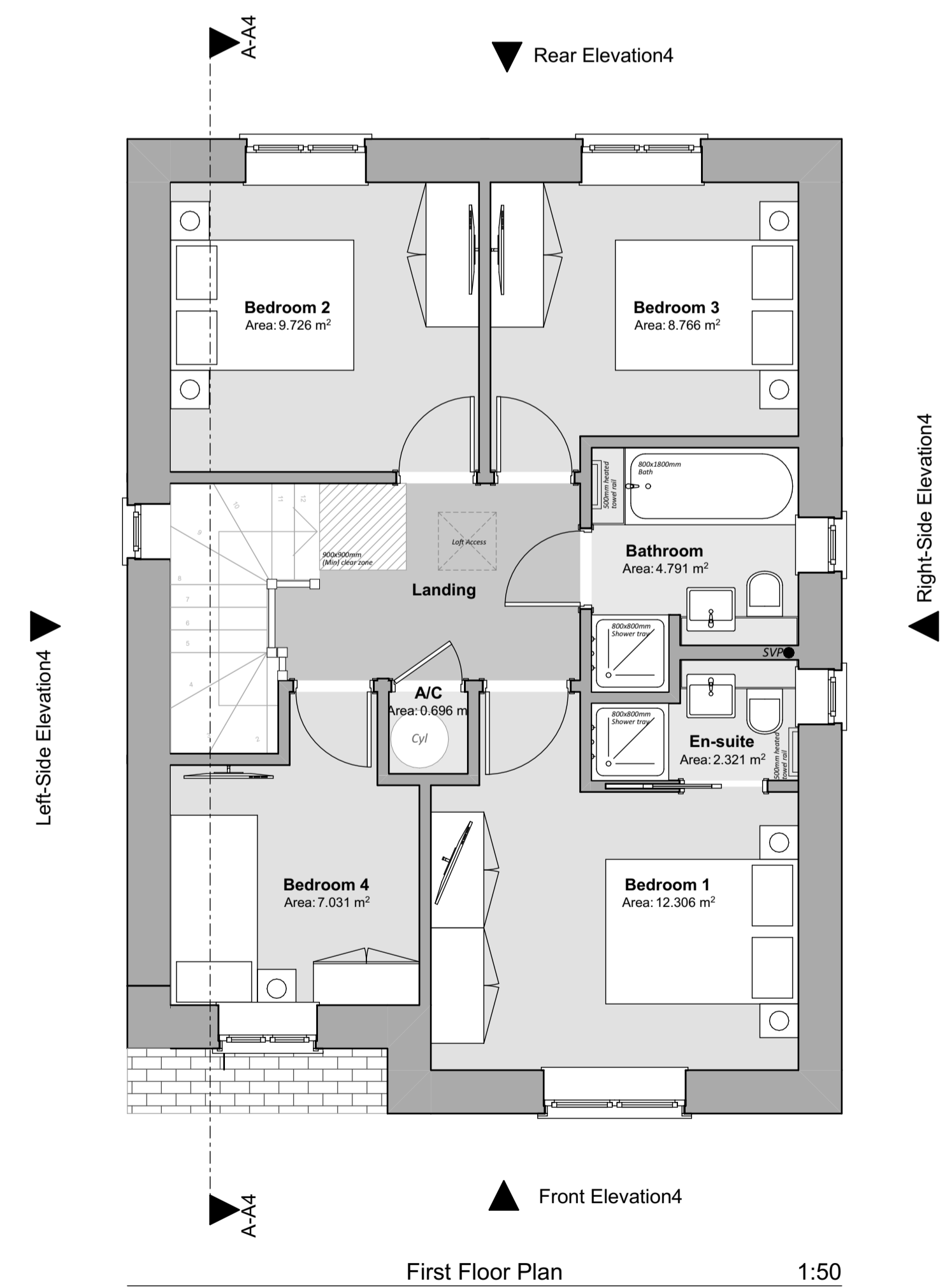

Revision:	Date:	By:	Notes:

16 Main Street,  
 Fishguard,  
 Pembrokeshire,  
 SA65 9JU  
 01348 635004/06  
 design@rlharchitectural.com  
 www.rlharchitectural.com

Client: WAKEFIELD DEVELOPMENTS PEMBROKESHIRE LIMITED  
 Scale: Noted  
 Date: April '23  
 Drawn: SE/RH  
 Job Title: Proposed Residential Development, Land East of Pilgrims Way, Roch, Pembrokeshire SA62 6BQ  
 Drawing Title: PLANNING DRAWINGS - 4 Bed House (2 Storey) - Floor Plans, Elevations & Section  
**R534 P-17**