

Floor Areas:

Total Gross Internal Ground Floor Area = 45.36m ² (488.25sqft)
Total Gross Internal First Floor Area = 45.36m ² (488.25sqft)
Total Gross Internal Area = 90.72m ² (976.50sqft)

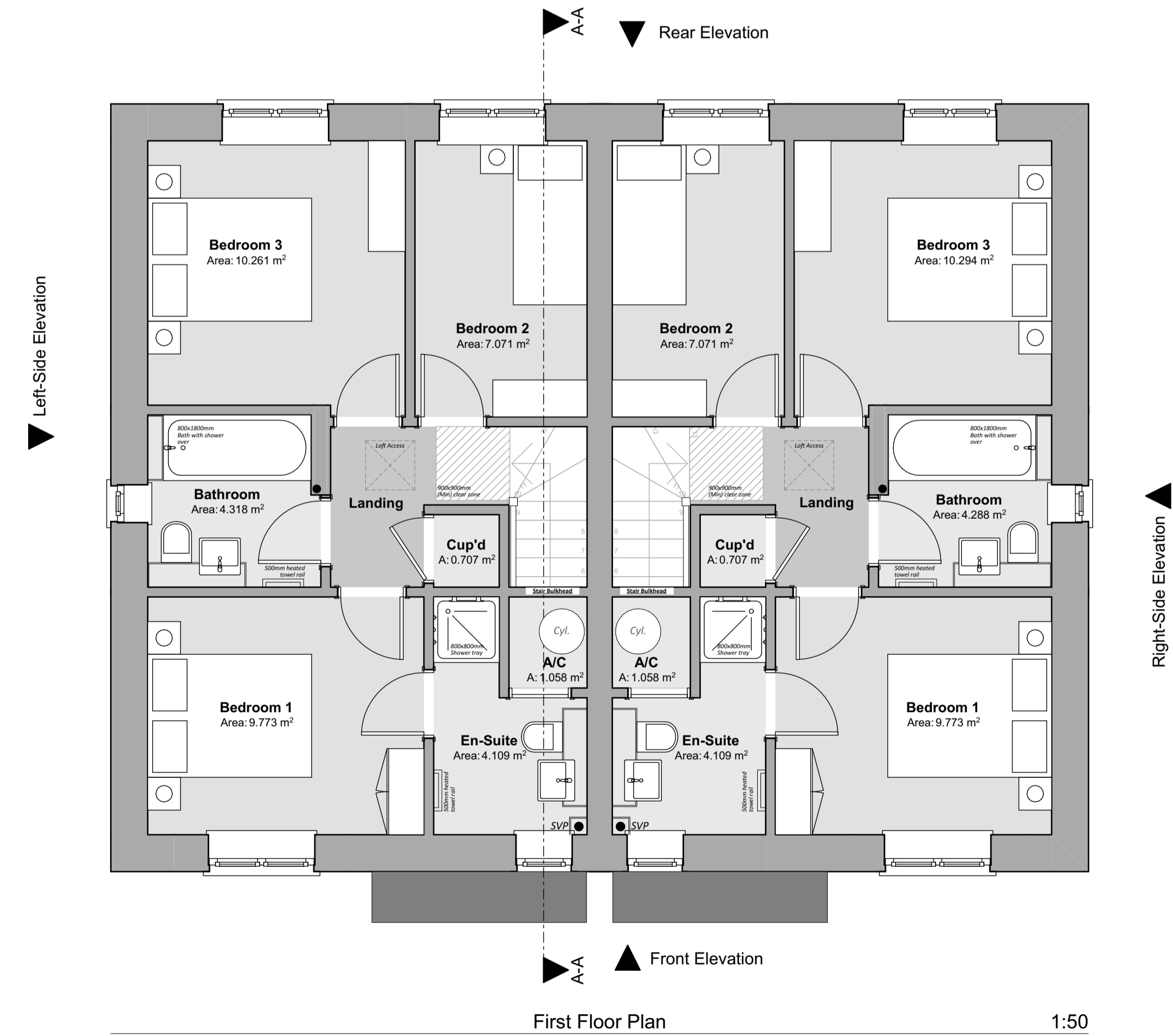

Revision:	Date:	By:	Notes:

16 Main Street,
Fishguard,
Pembrokeshire,
SA65 9JU
01348 635004/06
design@rlharchitectural.com
www.rlharchitectural.com

Client: WAKEFIELD DEVELOPMENTS PEMBROKESHIRE LIMITED	Scale: Noted Date: April '23 Drawn: FS/MG	Drawing Title: PLANNING DRAWINGS - 3 Bed Semi Det House - Floor Plans, Elevations & Section
Job Title: Proposed Residential Development, Land East of Pilgrims Way, Roch, Pembrokeshire SA62 6BQ		R534 P-14