



PART OF THE MATERIAL IN THIS PLOT HAS BEEN REPRODUCED FROM AN ORDNANCE SURVEY MAP © CROWN COPYRIGHT 2021. ALL RIGHTS RESERVED. LICENCE NUMBER 100022432.

KEY

- MAJOR CONTOUR (0.5m INTERVALS)
- MINOR CONTOUR (0.1m INTERVALS)
- CONTOUR LEVEL
- RETAINING STRUCTURE
- DWARF RETAINING STRUCTURE (UNDER 0.5m)
- SUDS EASEMENT

- NOTES:**
1. DRAWING TO BE READ IN CONJUNCTION WITH ALL OTHER RELEVANT PROJECT DRAWINGS AND WITH THE HEALTH AND SAFETY INFORMATION PROVIDED AND/OR WITHIN THE PRE-CONSTRUCTION INFORMATION.
 2. USE OF THIS DRAWING DOES NOT ABSOLVE THE CLIENT FROM HIS RESPONSIBILITIES UNDER THE HEALTH AND SAFETY: THE CONSTRUCTION DESIGN AND MANAGEMENT REGULATIONS 2015. THE PRINCIPAL DESIGNER IS REQUIRED TO CONTACT HYDROCK CONSULTANTS PRIOR TO PERMITTING THIS DRAWING TO BE USED IN CONNECTION WITH ANY CONSTRUCTION WORKS.
 3. BEFORE COMMENCEMENT OF ANY WORKS ASSOCIATED WITH THE DRAWING REFER TO ALL RELEVANT HEALTH AND SAFETY INFORMATION FOR THE WORKS INCLUDING RESIDUAL RISK INFORMATION.
 4. THE CONTRACTOR SHOULD COMPLY WITH HSG147 'AVOIDING DANGER FROM UNDERGROUND SERVICES' WHEN PLANNING, LOCATING AND EXCAVATING AROUND EXISTING SERVICES. IT IS KNOWN THAT EXISTING UTILITY COMPANY UNDERGROUND SERVICES AND APPARATUS ARE PRESENT WITHIN THE PROPOSED WORKS AREA AND IT IS THE CONTRACTORS RESPONSIBILITY TO LOCATE EXISTING SERVICES ON SITE ACCURATELY.
 5. INFORMATION REGARDING THE LOCATION AND DEPTH OF EXISTING SERVICES CANNOT BE GUARANTEED BY THE STATUTORY UNDERTAKER. THE CONTRACTOR SHALL CONDUCT THE WORKS WITH DUE REGARD FOR THE ECOLOGICAL AND ENVIRONMENTAL REQUIREMENTS OF THE SCHEME. THE DRAWINGS SHALL BE USED FOR THE INTENDED PURPOSE ONLY AND THIS DRAWING HAS BEEN BASED ON INFORMATION PROVIDED BY OTHER PARTIES AND HYDROCK DO NOT WARRANT THE ACCURACY OF THIS INFORMATION. DIMENSIONS SHALL NOT BE SCALED FROM THE DRAWING AND THE CONTRACTOR SHALL BE RESPONSIBLE FOR OBTAINING ALL DIMENSIONS AND LEVELS ON SITE FOR THE ACTUAL SETTING OUT OF THE WORKS. DIMENSIONS MARKED DIMENSIONS TO BE SITE CHECKED ARE SUBJECT TO CONFIRMATION BY THE CONTRACTOR BEFORE THE WORKS COMMENCE.
 6. HYDROCK IS NOT RESPONSIBLE FOR CHECKING DIMENSIONS ON SITE.
 7. HYDROCK IS NOT RESPONSIBLE FOR SETTING OUT GRID LINES, BUILDING LINE ETC.
 8. HYDROCK IS NOT RESPONSIBLE FOR DIMENSIONS USED IN THE ORDERING AND MANUFACTURING OF EQUIPMENT AND THIS SHALL BE THE RESPONSIBILITY OF THE CONTRACTOR.
 9. ALL FIGURED LEVELS ARE IN METRES AND RELATED TO EXISTING SURVEY GRID & DATUM UNLESS NOTED OTHERWISE.
 10. ALL FIGURED DIMENSIONS ARE IN METRES UNLESS NOTED OTHERWISE.
 11. TEMPORARY WORKS DESIGN ASSOCIATED WITH THE CONSTRUCTION OF THE WORKS SHALL BE RESPONSIBILITY OF THE CONTRACTOR.
 12. THE CONTRACTOR SHALL MAINTAIN FREE AND OPEN ACCESS TO PUBLIC HIGHWAY AND ADJACENT LANDS AT ALL TIMES DURING THE COURSE OF THE WORKS UNLESS OTHERWISE AGREED IN WRITING WITH THE INTERESTED PARTIES.
 13. THE CONTRACTOR SHALL BE RESPONSIBLE FOR THE DESIGN OF ALL TRAFFIC MANAGEMENT PROPOSALS & PHASING. SUCH DETAILS SHALL BE SUBMITTED TO THE LOCAL HIGHWAY AUTHORITY FOR APPROVAL PRIOR TO THE START OF THE WORKS. THE CONTRACTOR SHALL BE RESPONSIBLE FOR ALL ASSOCIATED COSTS AND ORDERS.
 14. CONFLICTING INFORMATION SHOWN ON THE ENGINEER'S DRAWINGS OR DISCREPANCIES BETWEEN THE INFORMATION GIVEN BY THE ENGINEER AND THAT PROVIDED BY OTHERS MUST BE REFERRED TO THE ENGINEER BEFORE THE WORKS COMMENCE.

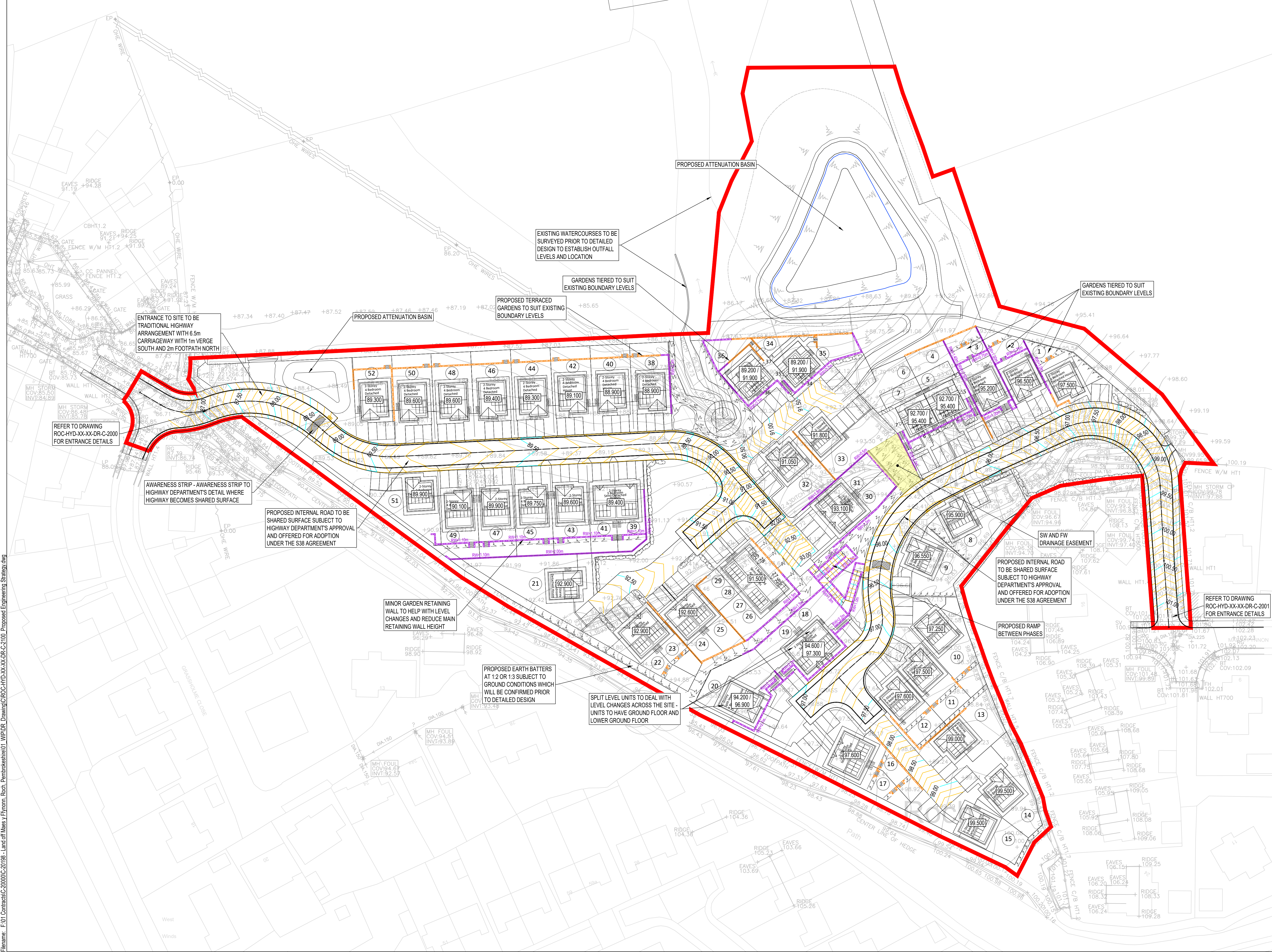

REVISIONS

NO.	DESCRIPTION	DATE	BY	CHECKED	DATE
P04	Red Line Boundary Updated	04/05/23	JSL	CS	04/05/23
S2	AS	26/04/23	JSL	CS	26/04/23
P03	Issued as part of Planning Pack	26/04/23	JSL	CS	26/04/23
S2	AS	26/03/22	CS	CS	26/03/22
P02	Updated to suit new layout	26/03/22	CS	CS	26/03/22
P01	First Issue	08/10/21	CS	CS	08/10/21
S2	ISL	08/10/21	CS	CS	08/10/21



CLIENT
WAKEFIELD DEVELOPMENTS
PEMBROKESHIRE LIMITED

PROJECT
RESIDENTIAL DEVELOPMENT AT
LAND OFF MAES Y FFYNNON, ROCH,
PEMBROKESHIRE

TITLE
PROPOSED ENGINEERING STRATEGY

HYDROCK PROJECT NO. C-20198	SCALE @ A1 1:500	STATUS FOR INFORMATION
DRAWING NO. (PROJECT ORIGINATOR-ZONE-LEVEL-TYPE-ROLE-NUMBER) ROC-HYD-XX-XX-DR-C-2100	REVISION P04	

Filename: F:\01_Contract\2020\02-20198 - Land off Maes y Ffynnon, Roch, Pembrokeshire\01_WP\DR_Drawing\ROC-HYD-XX-XX-DR-C-2100_Proposed Engineering Strategy.dwg